

**Product Applications:**

- Workspaces & offices
- Lobbies/Reception areas
- Schools, Colleges & Universities
- Administrative Centres
- Sports Centres
- Showrooms
- Laboratories

**Class II Product**

**Note:** Only use the LED driver supplied with your product. (isolated constant current power supply)

Part Number	SE2A-36T	SE2B-36T
Rated Voltage (V)	220~240	220~240
Frequency(Hz)	50~60	50~60
Power Adjustable	25W&36W	25W&36W
Power Factor	0.9	0.9
Lifetime	50,000H	50,000H
Max Lumens	3800	3800
Colour Temp	3000K, 4000K, 6500K	3000K, 4000K, 6500K
Beam Angle	120°	120°
CRI	>80	>80
Type	TP(a)	TP(b)
Dimensions(mm)	595X595X26	595X595X26

**Installation**

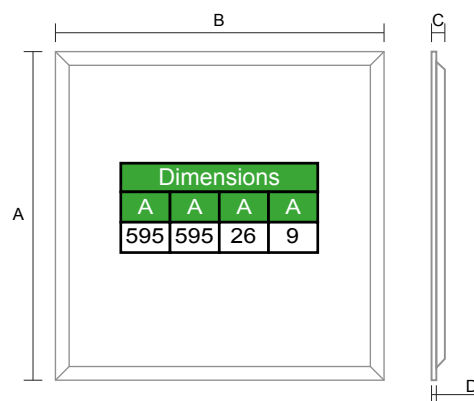

1. Switch the power off.
2. Lift the recessed modular fitting into the ceiling.
3. Wire the led panel driver to the mains.
4. Place the panel into the recessed ceiling and connect the male/female connector.
5. Adjust into place.



The power is selectable between 25/36W using the wattage switch on the driver during installation.



The colour is selectable between 3000/4000/6500K using the CCT switch on the input cable during installation.

This product must be installed in accordance with the latest edition of Building Regulations and carried out by a qualified electrician in accordance with the latest IEE Wiring Regulations. Before commencing any installation or maintenance work, ensure that the mains supply is switched off and the appropriate MCB or fuse is isolated. This product contains a light source of efficiency class <E> to regulation(EU) No 2019/2015

**Caution - Risk of electric shock**



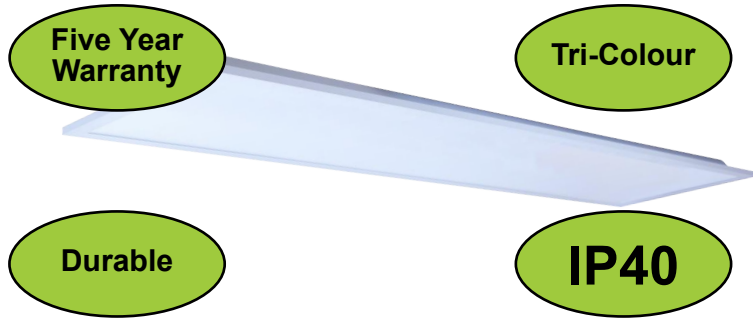

**Product Applications:**

- Workspaces & offices
- Lobbies/Reception areas
- Schools, Colleges & Universities
- Administrative Centres
- Sports Centres
- Showrooms
- Laboratories

**Class II Product**

**Note:** Only use the LED driver supplied with your product. (isolated constant current power supply)

Part Number	SE2A-123T	SE2B-123T
Rated Voltage (V)	220~240	220~240
Frequency(Hz)	50~60	50~60
Power Adjustable	25W&36W	25W&36W
Power Factor	0.9	0.9
Lifetime	50,000H	50,000H
Max Lumens	3600	3600
Colour Temp	3000K, 4000K, 6500K	3000K, 4000K, 6500K
Beam Angle	120°	120°
CRI	>80	>80
Type	TP(a)	TP(b)
Dimensions(mm)	1195X295X33	1195X295X33

**Installation**

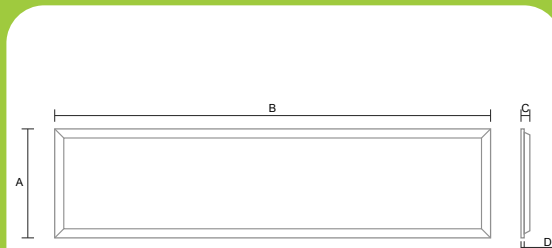

Dimensions			
A	A	A	A
1195	295	33	9

1. Switch the power off.
2. Lift the recessed modular fitting into the ceiling.
3. Wire the led panel driver to the mains.
4. Place the panel into the recessed ceiling and connect the male/female connector.
5. Adjust into place.

The power is selectable between 25/36W using the wattage switch on the driver during installation.

The colour is selectable between 3000/4000/6500K using the CCT switch on the input cable during installation.

This product must be installed in accordance with the latest edition of Building Regulations and carried out by a qualified electrician in accordance with the latest IEE Wiring Regulations. Before commencing any installation or maintenance work, ensure that the mains supply is switched off and the appropriate MCB or fuse is isolated. This product contains a light source of efficiency class <E> to regulation(EU) No 2019/2015

**Caution - Risk of electric shock**



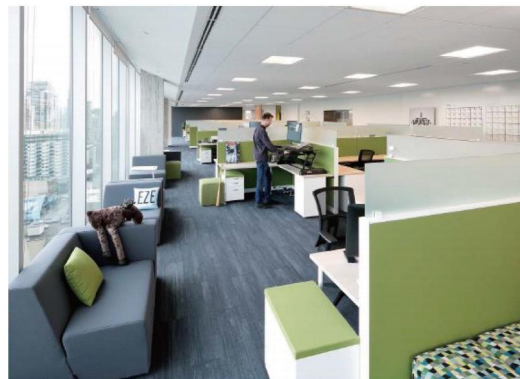
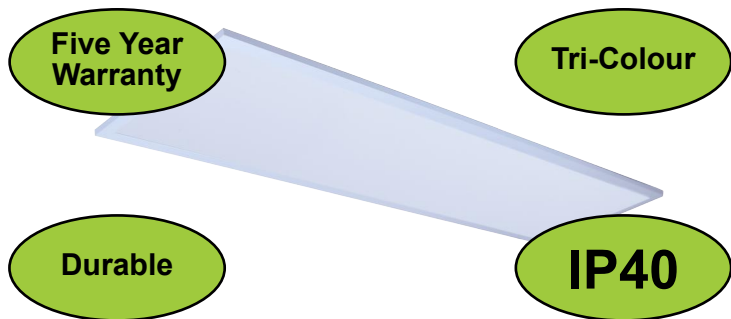

**Product Applications:**

- Workspaces & offices
- Lobbies/Reception areas
- Schools, Colleges & Universities
- Administrative Centres
- Sports Centres
- Showrooms
- Laboratories

**Class II Product**

**Note:** Only use the LED driver supplied with your product. (isolated constant current power supply)

Part Number	SE2A-126T	SE2B-126T
Rated Voltage (V)	220~240	220~240
Frequency(Hz)	50~60	50~60
Power Adjustable	38W&56W	38W&56W
Power Factor	0.9	0.9
Lifetime	50,000H	50,000H
Max Lumens	5800	5800
Colour Temp	3000K, 4000K, 6500K	3000K, 4000K, 6500K
Beam Angle	120°	120°
CRI	>80	>80
Type	TP(a)	TP(b)
Dimensions(mm)	1195X595X33	1195X595X33

**Installation**

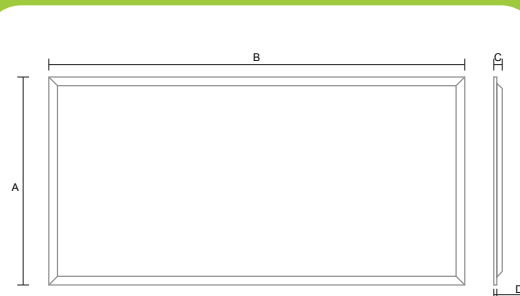

Dimensions			
A	A	A	A
1195	595	33	9

1. Switch the power off.
2. Lift the recessed modular fitting into the ceiling.
3. Wire the led panel driver to the mains.
4. Place the panel into the recessed ceiling and connect the male/female connector.
5. Adjust into place.



The power is selectable between 25/36W using the wattage switch on the driver during installation.



The colour is selectable between 3000/4000/6500K using the CCT switch on the input cable during installation.

This product must be installed in accordance with the latest edition of Building Regulations and carried out by a qualified electrician in accordance with the latest IEE Wiring Regulations. Before commencing any installation or maintenance work, ensure that the mains supply is switched off and the appropriate MCB or fuse is isolated. This product contains a light source of efficiency class <E> to regulation(EU) No 2019/2015

**Caution - Risk of electric shock**

